



ADOBE ROOT CERTIFICATE CHECK

Steps for checking the Adobe Root CA certificate

Issue Date: 26.01.2011

Release: 1.0

Contents

1	Introduction	3
2.1	<i>Adobe Root CA Check</i>	3

1 Introduction

The subscriber, end user or relying party should ensure that the certificate received was indeed issued by the Post.Trust CA for Adobe CDS by verifying the thumbprint of the issuing CA certificate against that published for the Post.Trust CA For Adobe CDS.

Where a private key container is also issued, the user application which accesses the key should verify that the key matches the corresponding certificate issued and verified above.

2.1 Adobe Root CA Check

A signed or certified document can be checked by completing the following steps. Adobe acrobat 9.0 is used to highlight the steps involved.

On the left hand side there should be an icon that allows you to verify the signature details of the signed/certified document.

Click this option as highlighted below.

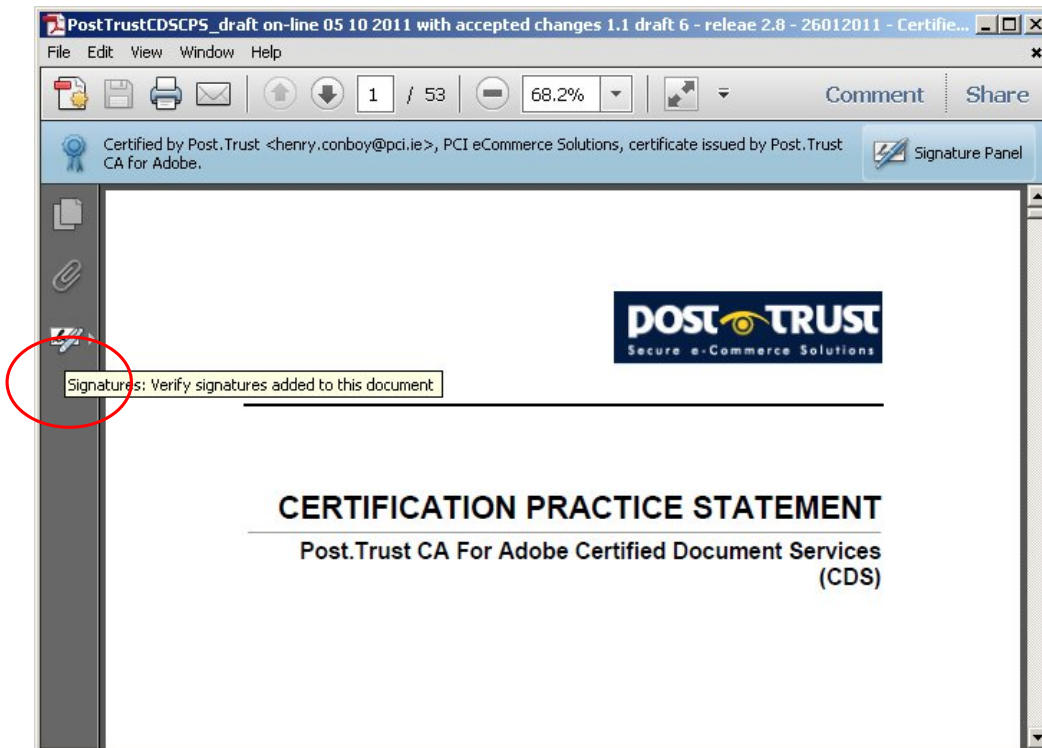

When click ed a number of options will appear. One of the options will be to 'Show Signature Properties...'

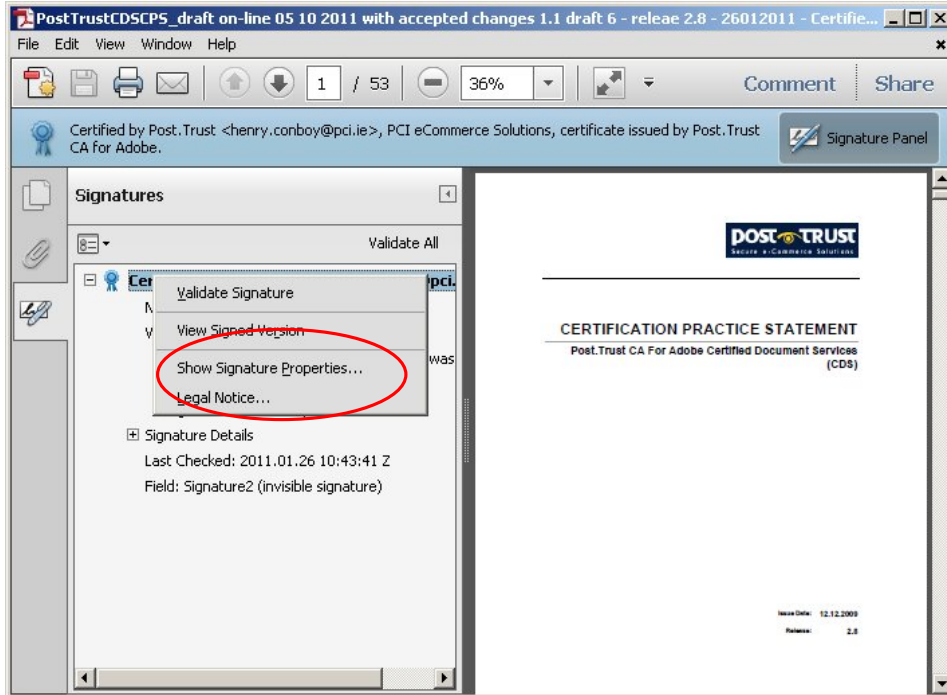

Select the 'Show Signature Properties...' option and the following screen will appear. Click the option to 'Show Certificate' as highlighted

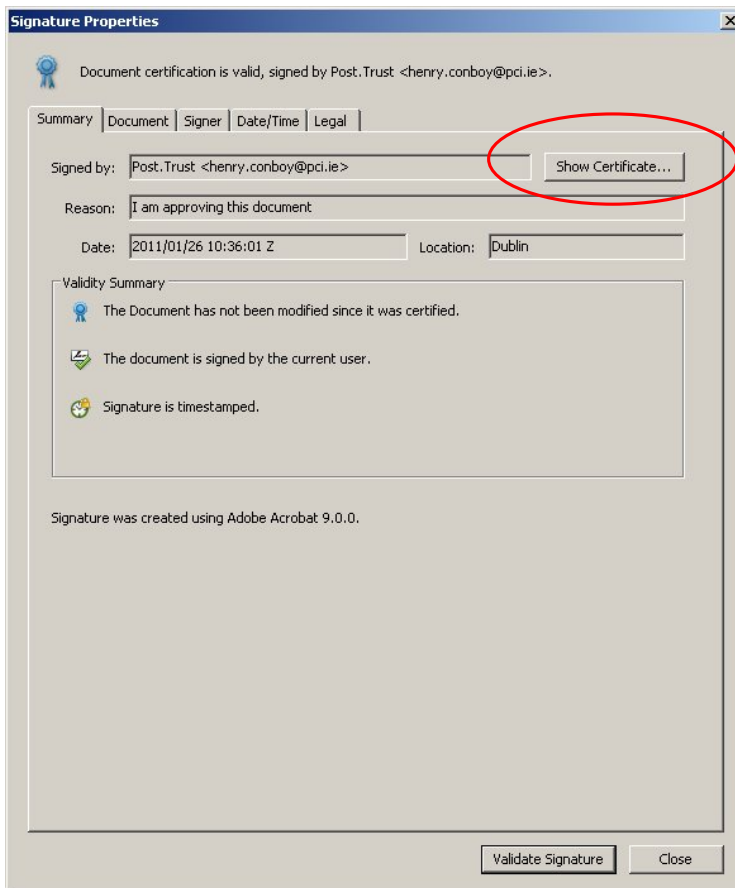

If the option, Show all certification paths found, as highlighted below is not selected then select it.

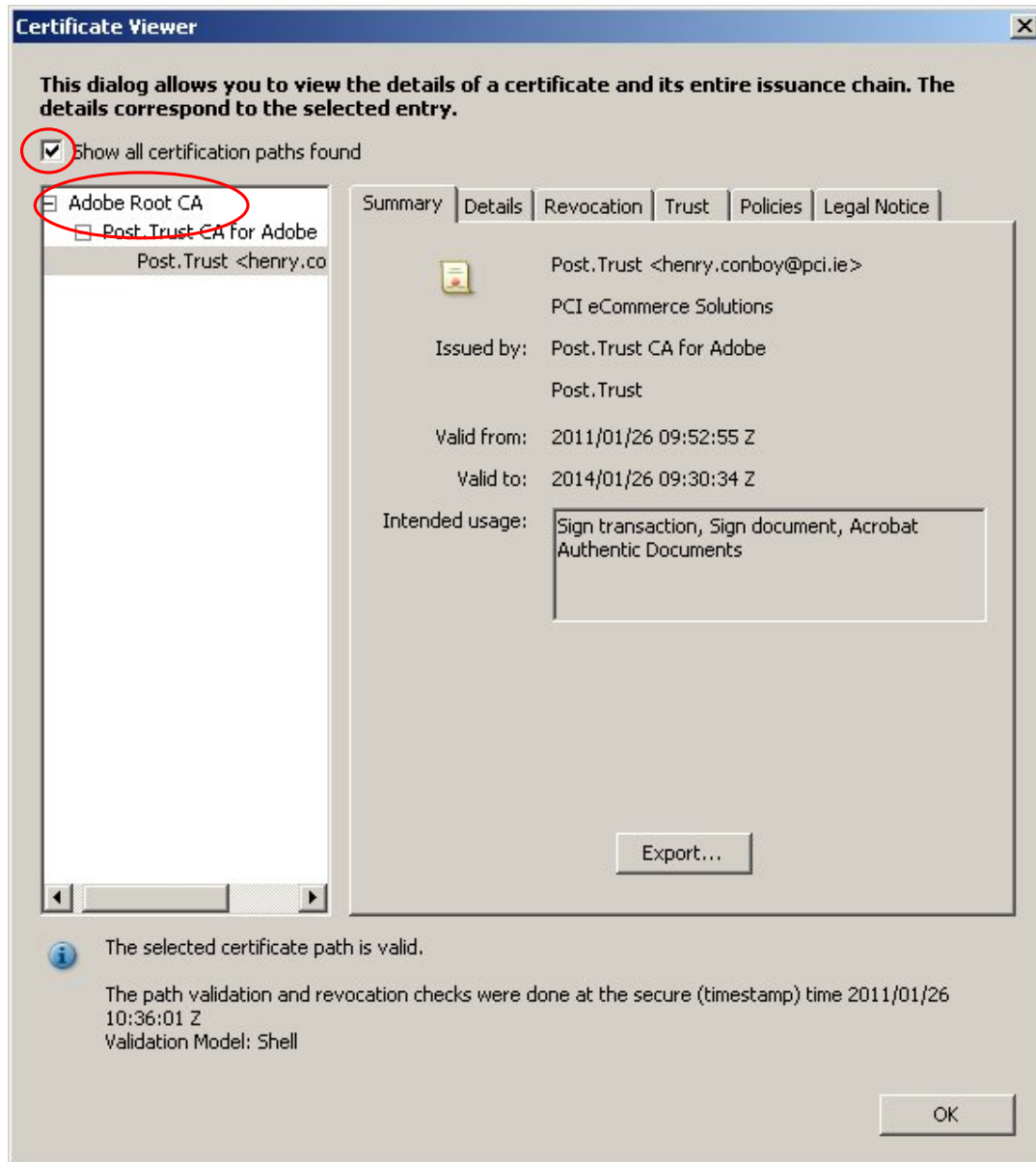

Select the Adobe Root CA if it is listed as per the screen shot above. If Adobe Root CA is not listed then there is a problem.

When the Adobe Root CA is selected the Summary details will contain information about the certificate.

Once the Adobe Root CA is selected then you can view the certificate details by clicking the 'Details' tab.

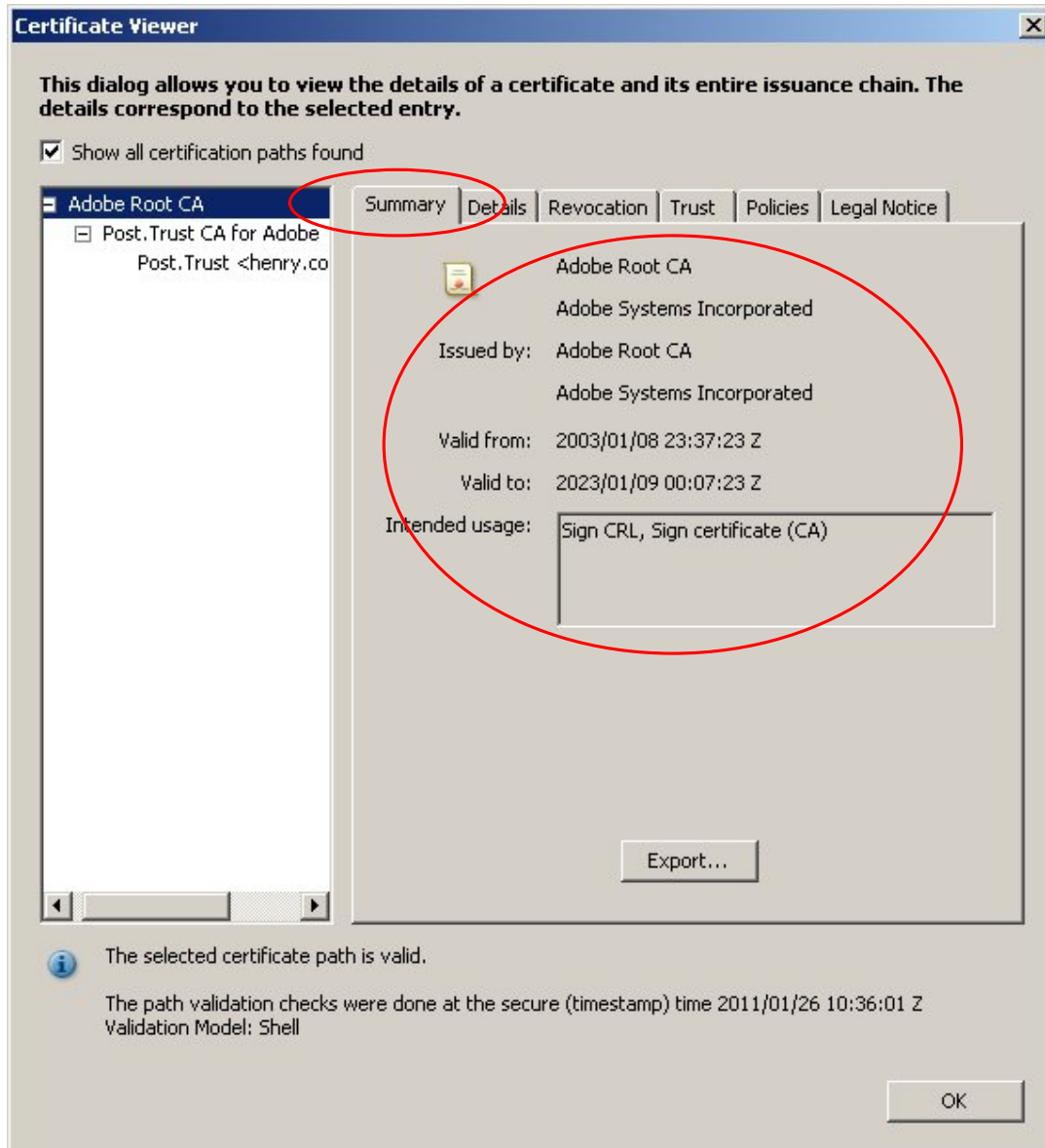

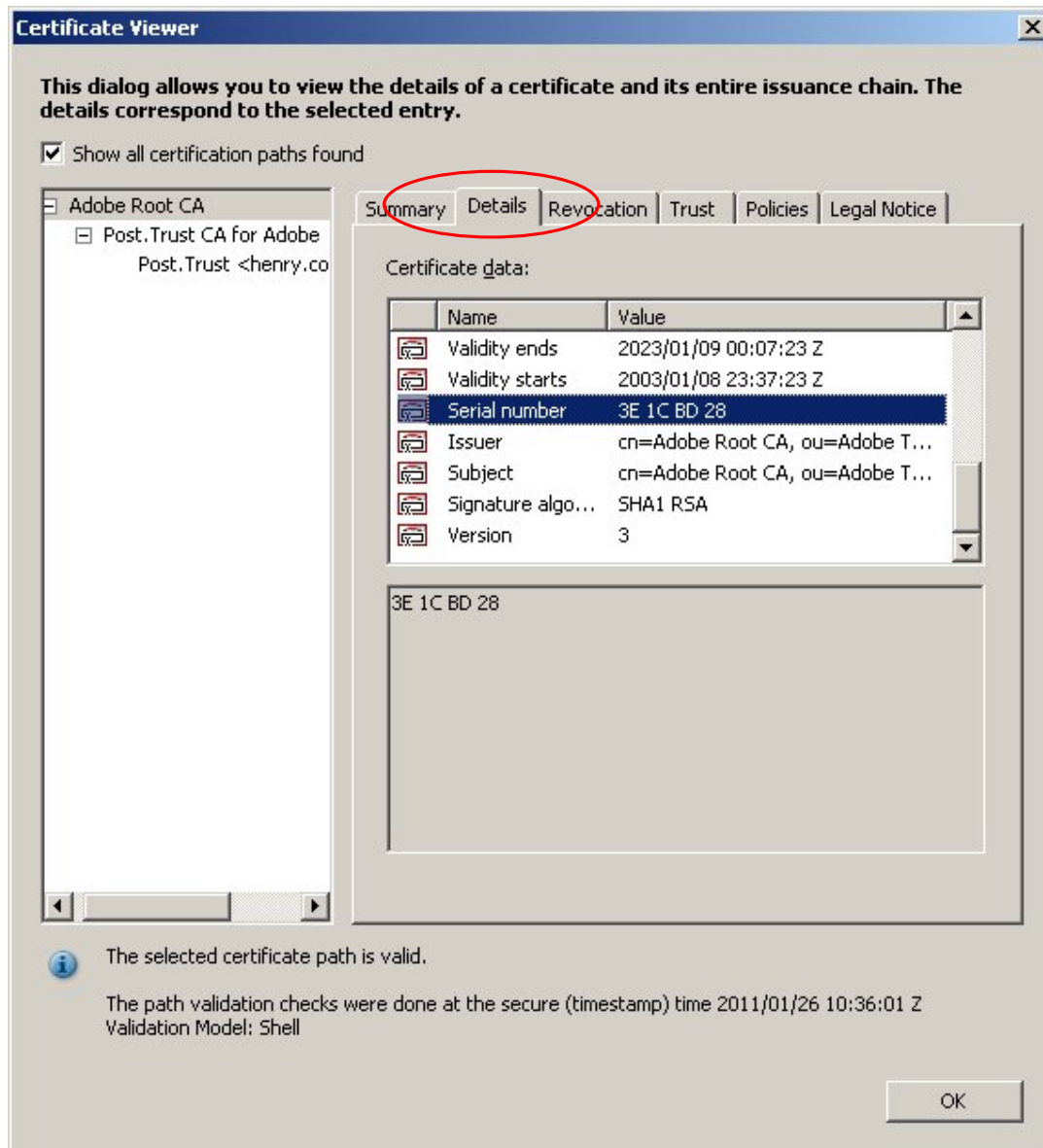

When in the Details tab you should check the serial number which should be as follows;

3E 1C BD 28

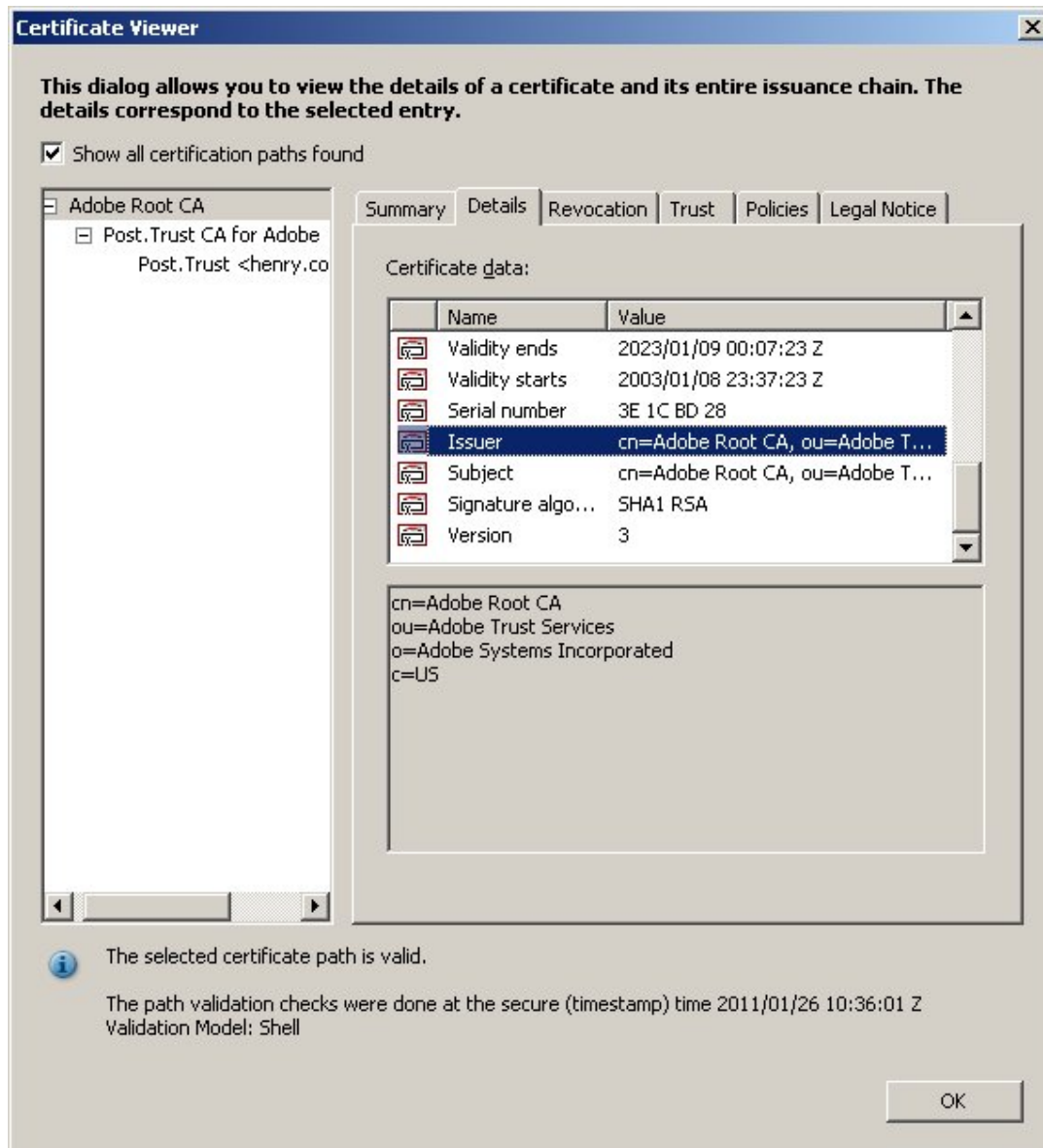

You can also check that the issuer is correct. The details should be;

cn=Adobe Root CA

ou=Adobe Trust Services

o=Adobe Systems Incorporated

c=US

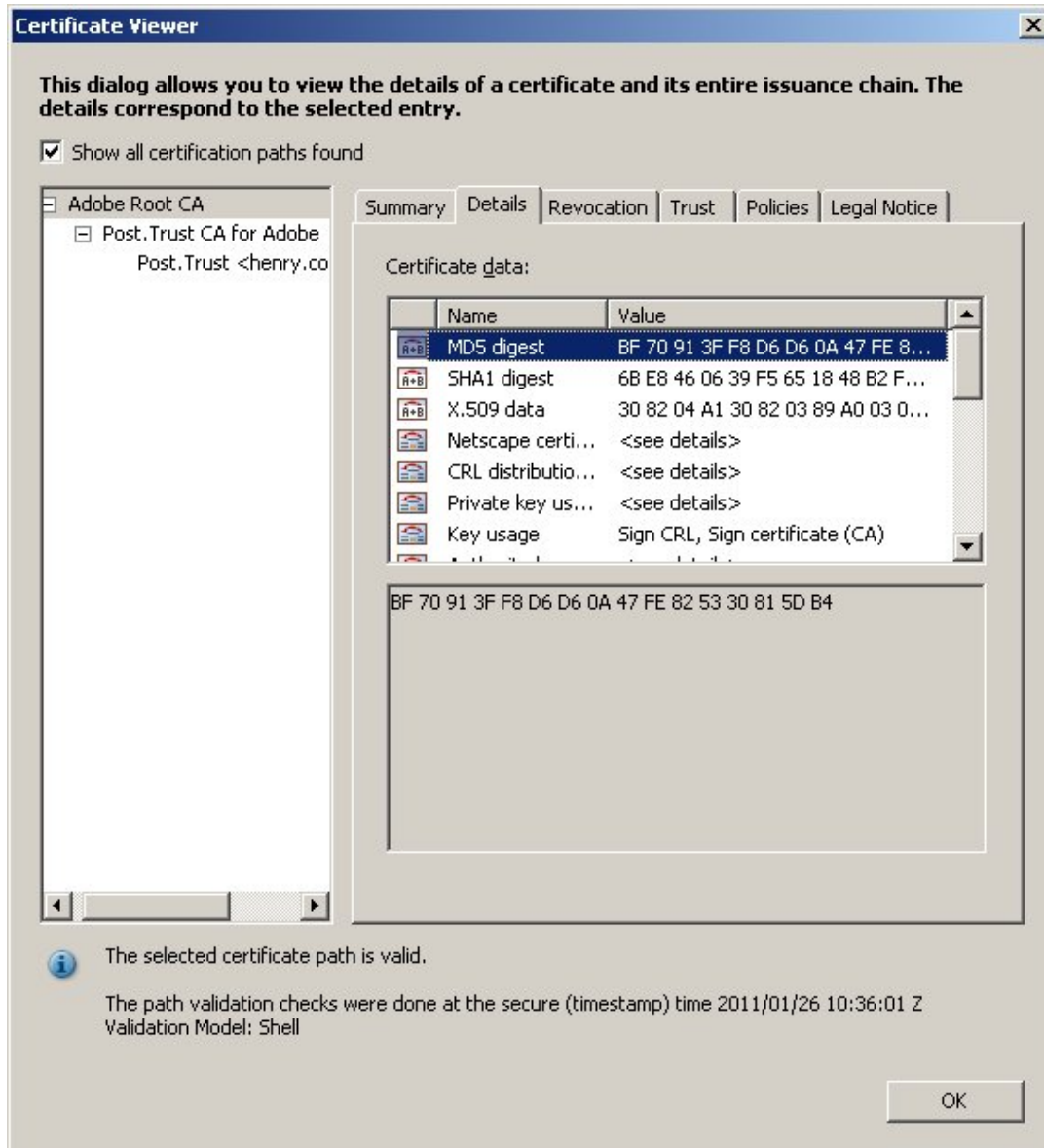

The MD5 digest should also be checked. The details should be as follows;

BF 70 91 3F F8 D6 D6 0A 47 FE 82 53 30 81 5D B4

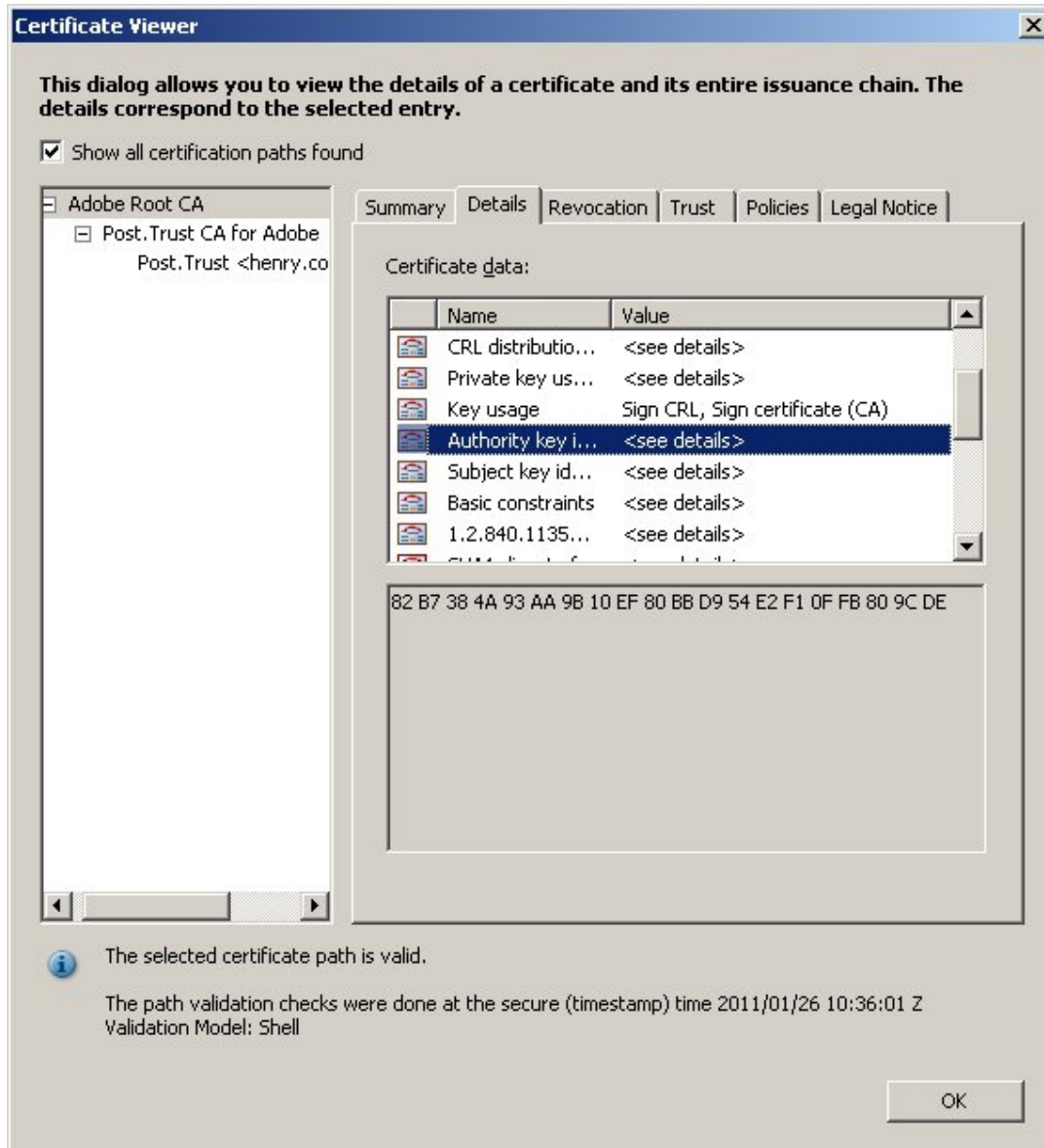

The Authority Key ID should also be checked. The details should be as follows;

82 B7 38 4A 93 AA 9B 10 EF 80 BB D9 54 E2 F1 0F FB 80 9C DE

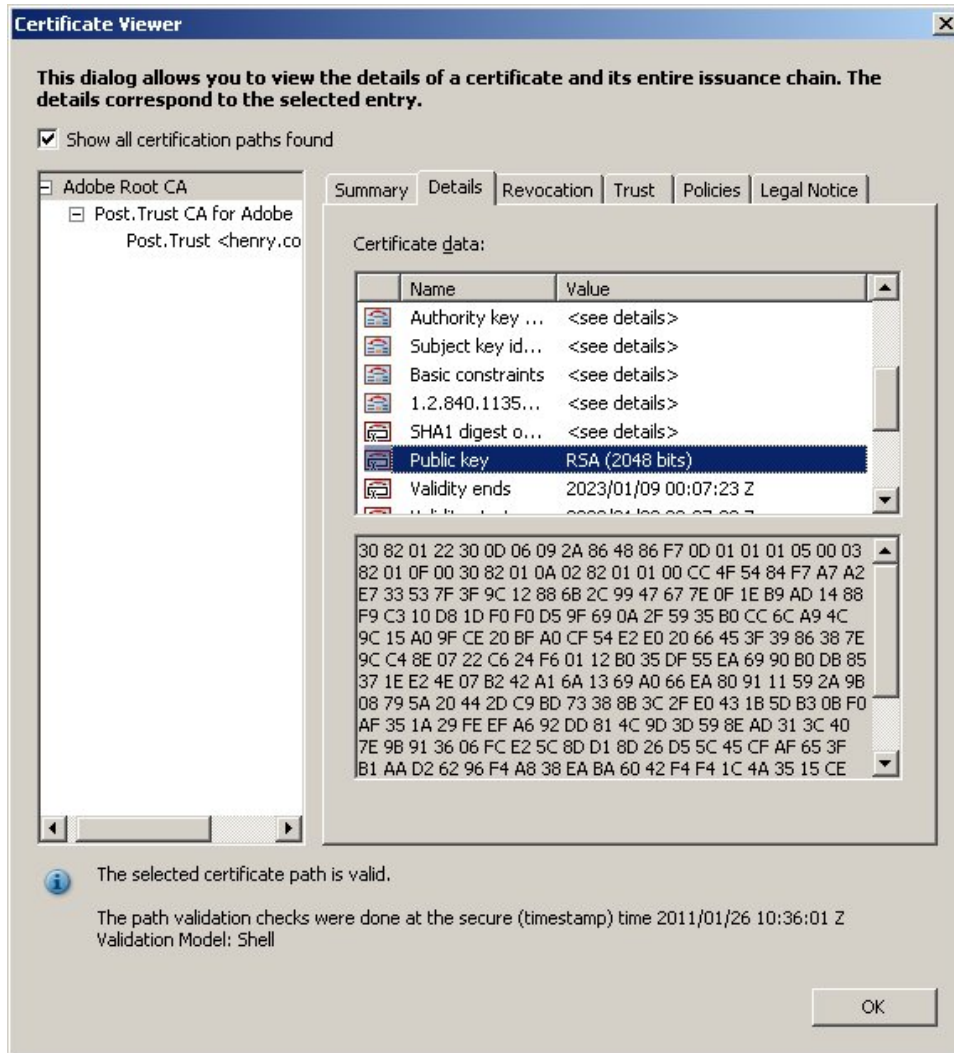

The public key can also be check and should be as follows;

```

30 82 01 22 30 0D 06 09 2A 86 48 86 F7 0D 01 01 01 05 00 03 82 01 0F 00 30 82 01 0A 02 82 01 01 00
CC 4F 54 84 F7 A7 A2 E7 33 53 7F 3F 9C 12 88 6B 2C 99 47 67 7E 0F 1E B9 AD 14 88 F9 C3 10 D8 1D
F0 F0 D5 9F 69 0A 2F 59 35 B0 CC 6C A9 4C 9C 15 A0 9F CE 20 BF A0 CF 54 E2 E0 20 66 45 3F 39 86 38
7E 9C C4 8E 07 22 C6 24 F6 01 12 B0 35 DF 55 EA 69 90 B0 DB 85 37 1E E2 4E 07 B2 42 A1 6A 13 69
A0 66 EA 80 91 11 59 2A 9B 08 79 5A 20 44 2D C9 BD 73 38 8B 3C 2F E0 43 1B 5D B3 0B F0 AF 35 1A
29 FE EF A6 92 DD 81 4C 9D 3D 59 8E AD 31 3C 40 7E 9B 91 36 06 FC E2 5C 8D D1 8D 26 D5 5C 45 CF
AF 65 3F B1 AA D2 62 96 F4 A8 38 EA BA 60 42 F4 F4 1C 4A 35 15 CE F8 4E 22 56 0F 95 18 C5 F8 96 9F
9F FB B0 B7 78 25 E9 80 6B BD D6 0A F0 C6 74 94 9D F3 0F 50 DB 9A 77 CE 4B 70 83 23 8D A0 CA 78
20 44 5C 3C 54 64 F1 EA A2 30 19 9F EA 4C 06 4D 06 78 4B 5E 92 DF 22 D2 C9 67 B3 7A D2 01 02 03
01 00 01
    
```